

Quick Start Guide

VGD-100+

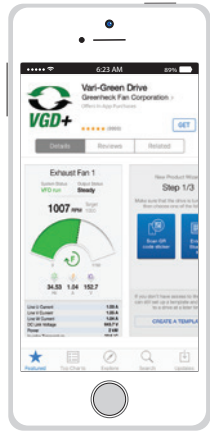

1. Install the Vari-Green™ Drive app on your mobile device. The app is available on the Apple app store. Power up the Vari-Green Drive.

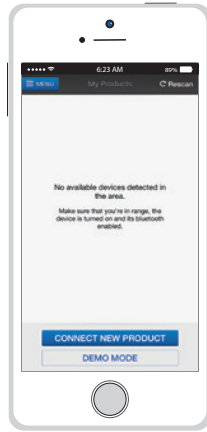

2. Open the Vari-Green Drive app and select “Connect New Product”. Follow the steps in the New Product Wizard.

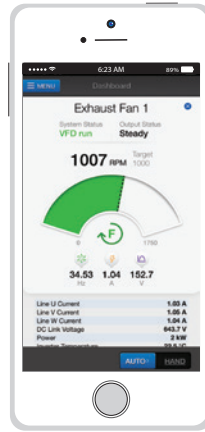

3. From the Dashboard screen, select “Menu”. In the slide-out menu, select “Setup”.

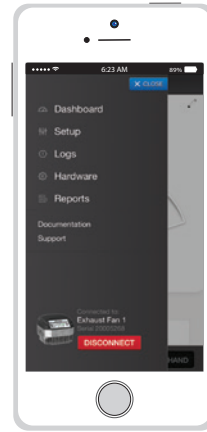

4. Select the desired control mode from the list in the setup menu.

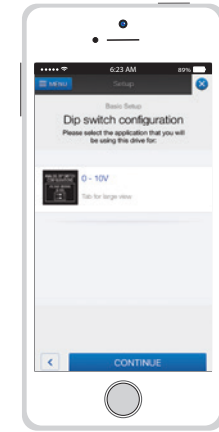
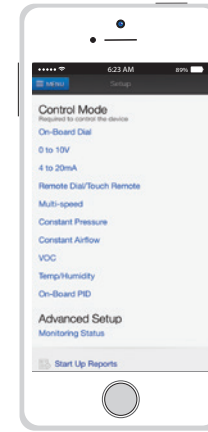

5. Verify the Vari-Green Drive dip switches match the dip switch diagram shown in the setup wizard. Tap “Continue”.

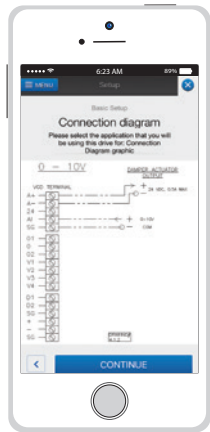

6. Verify the drive wiring connections match the app wiring diagram. Tap “Continue”.

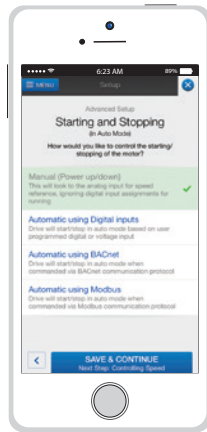

7. Select how you wish to start/stop the fan. If anything other than manual, configure the inputs/outputs and verify all additional wiring connections. Tap “Save & Continue”.

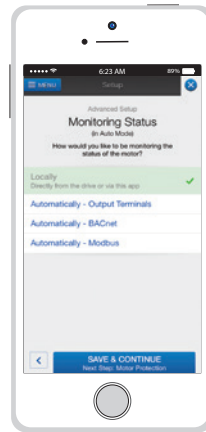

8. Select how you wish to monitor the Vari-Green Drive/fan. If anything other than locally, configure the inputs/outputs and verify the appropriate wiring connections. Tap “Save & Continue”.

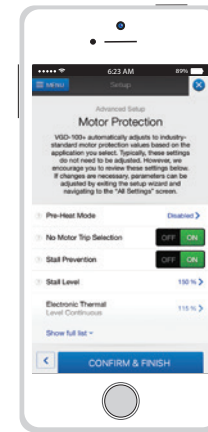

9. Optional: Review and adjust the motor protection settings. These are factory defaulted to industry standards. Tap “Confirm & Finish”.

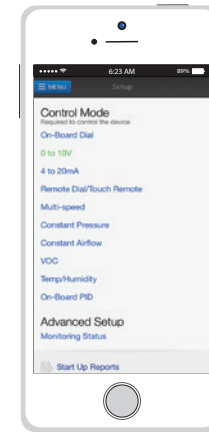

10. The control mode you have just programmed will be highlighted, indicating completion. A snapshot of the configured inputs/outputs can be viewed from the dashboard screen.

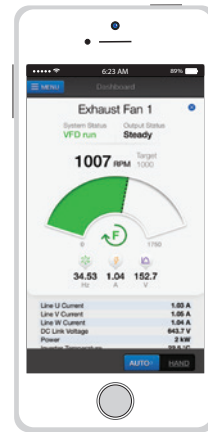



Scan to download the app



Vari-Green™ Drive App

The Vari-Green Drive app can connect your mobile device to any Vari-Green Drive Model 100+ and offers many features to make setup and operation a breeze.

- Dashboard – monitor fan performance in real time, view drive I/O configuration
- ‘Hand’ Mode – manually control fan speed
- Setup Menu – configure drive I/O terminals
- Logs – view drive history including faults and settings adjustments, send directly to technical support
- Reports – create, sign, and send startup reports
- Templates – create and save configuration templates and load to an unlimited number of drives for quick setup
- Support – contact technical support via phone call or email

Factory Programmed Parameters

The Vari-Green Drive comes installed, wired, and programmed from the factory to greatly reduce the start-up time when using a variable frequency drive. Factory programmed settings are accessible for adjustment in app in the “All Settings” menu, and include:

- Motor FLA
- Motor voltage
- Motor RPM
- Carrier Frequency
- Low/High Frequency Limits
- Acceleration/Deceleration Times
- Damper Time Delay
- Fan Model and Size



CONTROL WIRING			
Terminal	Description	Rating	Notes
A+	Damper Output	24VDC / 0.5A Max	Programmable activation modes
A-			
24	24VDC Output	24VDC / 50mA Max	Voltage or current input configurable via analog dip switches 1 & 2
AI	Analog Input	0-24V / 0-10V / 4-20mA	Can be configured to “N.O.” (default) or “N.C.” Functions: run, fault, ...
SG			
O1	Relay Output	125VAC-0.5A / 250VAC-0.25A / 30VDC-2.0A / 125VDC-0.24A / 220VDC-0.24A	Can be configured to “Active High” (default) or “Active Low” Functions: enable, limit switch, fireman’s override, speed A, speed B, shutdown
O			
O2			
V1	Voltage Input 1	12-250V AC/DC / 8mA Max draw on at 10V min, Off at 3V Max 52kOhm input impedance	Can be configured to “Active High” (default) or “Active Low” Functions: enable, limit switch, fireman’s override, speed A, speed B, shutdown
V2			
V3			
V4	Voltage Input 2		
D1	Dry Input 1	24VDC when open / Short to SG to activate	Can be configured to “Active High” (default) or “Active Low” Functions: enable, limit switch, firemen’s override, speed A, speed B, shutdown
D2	Dry Input 2		
SG	Input Common		
+	RS-485 Communications	N/A	Modbus, BACnet
-			
SG			